

NORTH SOMERSET LIFE

SUMMER 2023

Discover North
Somerset this
summer





time to care...

F♥storing North Somerset



**As a foster carer with
North Somerset you benefit from:**

- relief from Council Tax payments
- a weekly allowance of up to £424.05 per child
- free ongoing training and support
- caring for local children
- the Mockingbird Family Model.



Step forward and make a difference

01275 888 999

fostering.n-somerset.gov.uk



Dear Reader

In 2019, North Somerset residents voted for a collaborative council where councillors of all parties and none worked together to get things done for our community. In 2023, this approach was reinforced and our Partnership Administration was bolstered with renewed energy and purpose.

Our new Executive team will provide political leadership to the council and work with the local councillors you elected from communities across North Somerset to deliver the changes you want to see. In this edition of *Life*, you can read more about the new council and your councillors.

Elections can be an important opportunity for councillors to listen to the views of the people they represent and challenge themselves about local priorities. In the coming weeks, the council will be refreshing our vision and ambitions for the years ahead. As part of this, we would like to hear from you.

Please get in touch with your local councillor, or any member of the Executive, if you have ideas, suggestions – or gripes!

A theme that came up time and again on the doorsteps was transport. In this edition you can read more about the exciting and innovative new on-demand WESTlink bus service, and our latest round of funding to make walking and cycling improvements. The cost-of-living pressures that are facing us all were a common topic – and you can read about our £2.6m investment in a new package of support for those who most need it.

We also heard a lot of comments about the condition of our roads and pavements and the need to tackle the historic lack of investment in our infrastructure. We are actively working to find ways to better tackle this – and to persuade the government to do much more to increase funding for these essential services.

There is no magic wand to solve all the challenges we face as a community. We can, however, believe in the power of our community to work together to meet these challenges. As a council, we will continue to have faith in the extraordinary strength of partnership to create a brighter, fairer future for everyone in North Somerset.

Cllr Mike Bell

The Executive

Cllr Mike Bell, Leader of North Somerset Council

Cllr Catherine Gibbons, Deputy Leader

Cllr Mark Canniford

Cllr James Clayton

Cllr Jenna Ho Marris

Cllr Mike Solomon

Cllr Annemieke Waite

Cllr Roger Whitfield

Cllr Hannah Young

Contents



- 4** News update
- 10** Get set for summer
- 14** Community events across the area
- 16** Ride your way through North Somerset
- 18** Launch of on-demand buses
- 20** Nailsea Library's new home
- 24** Walk – Stroll along the Strawberry Line
- 26** Take action on food waste
- 30** Meet your new council
- 38** Continued cost-of-living support
- 44** Improving play areas for all
- 47** Contact details

North Somerset Council does not endorse or recommend any commercial products or services advertising in *Life* magazine.

This publication is available in large print, Braille or audio formats on request. Help is also available for people who require council information in languages other than English.

Applicants needed for Portishead Post Office

Retailers in Portishead who could set up a Post Office Local in their existing store are needed to step forward.



Post Offices play an important role in communities but Portishead is currently without one.

Post Office Ltd is looking for a successful retailer who can integrate Post Office services into their business, so they can be offered over the same opening hours.

Successful outlets are found in many types of premises, such as gift shops, garden centres, stationery shops and cafés.

The exact layout and design will be agreed with you to suit your business.

The successful applicant will need a number of transferable skills, including superb customer service, excellent business management, ability to communicate effectively and easily with your branch team and customers, and strong conversational skills.

The closing date is Friday 1 September. Find out more at www.runapostoffice.co.uk

Contacting the council if you don't have internet access

Help is available over the phone if you, or someone you know, can't access council services online.

The most popular numbers are:

- council tax and benefits – 01934 888 144
- waste and recycling – 01934 888 802
- planning – 01934 888 802
- roads and pavements – 01934 888 802
- housing enquiries – 01934 426 330
- Care Connect (adult and children's social care) – 01934 888 801.

For anything else, call 01934 888 888. This is an automated service. Ask for the service you want and you'll be put through.

Lines are open 9am-5pm, Monday to Friday (Care Connect line open 8am-6pm, Monday to Friday).

If you can go online to access council services, please do so.

Going online makes it easier for you and also saves the council money, which can then be used to provide essential services to local residents.

It also leaves the telephone lines available for the most vulnerable residents.

Visit www.n-somerset.gov.uk/myaccount

Face-to-face support

People who can't get online to access council services are now able to get face-to-face support from library staff across the area.

A trial scheme launched last year where customer service officers visited libraries to help people in person who couldn't access services online or over the phone.

The service was well received but usage very low in most locations.

An alternative plan has been developed where library staff can now offer this face-to-face support rather than customer services officers.

This means people can access support for longer periods and in more locations.

For complex enquiries where an immediate answer can't be given, an appointment will be offered for a later date.

This new system is now being rolled out gradually across all libraries.



Frequency of North Somerset *Life* reducing

North Somerset *Life* magazine is reducing in frequency from next year.

From 2024 the magazine will be distributed twice a year, down from its current three issues a year, as part of North Somerset Council's budget strategy.

The monthly *Life* email newsletter will continue to keep readers up-to-date with council news, events and features in-between printed editions of the magazine.

Subscribe online by visiting www.northsomersetlife.co.uk and click on the 'sign up to our email newsletter' tab.

If you, or someone you know, would be interested in receiving this e-newsletter but aren't online, free internet access is available in all local libraries.

Posters are displayed in libraries to show what stories appear in each month's edition and library staff are

happy to show you how to log on to read them.

Pages from this website can also be printed out for free. Just ask at the counter for help.

Large print and audio versions of the magazine will continue to be produced for anyone who needs them in those formats.

If you would like to feed back any comments or have any queries regarding *Life* reducing in frequency, please email editor@n-somerset.gov.uk



Coffee morning for landlords

There is a huge shortage of affordable homes for local residents – so North Somerset Council is offering information and incentives to landlords in the area.

If you're a landlord and would be interested in hearing what the council's lettings team has to offer, pop into the Stable Games Room, in the High Street, Weston-super-Mare, from 8.45am to 2pm on Wednesday 12 July.

Representatives from the National Residential Landlords Association will be there to answer questions on the Renters Reform Bill, along with Citizens Advice Bureau and Lendology.

Find out more by calling the lettings team on 01934 426 483.



Grants for home energy measures



Low income households in North Somerset without gas central heating may be eligible for a new round of funding to install energy-saving, low carbon heating measures in their homes.

North Somerset Council has partnered with Bath and North East Somerset Council and Bristol City Council on the second round of the Bright Green Homes project, which is being administered by Bristol City Leap.

The scheme will deliver energy efficient and cost-saving measures which also reduce carbon emissions, as part of the council's commitment to tackling the climate emergency.

A wide range of insulation and low-carbon technologies can be funded, including:

- external wall insulation
- cavity wall insulation
- loft insulation
- underfloor insulation
- air source heat pump
- solar PV panels.

To qualify for the funding you must meet these criteria:

- your property must not use gas central heating – the scheme is only open to people who use oil, wood, LPG or electric heating systems
- have a combined annual household income of £31,000 or lower
- live in North Somerset.

If you meet the eligibility criteria, complete the online questionnaire at **www.smartsurvey.co.uk/s/56OGQZ** and the project team at Bristol City Leap will contact you to discuss the next steps.

If you have any questions email **domestic@bristolcityleap.co.uk**, visit **www.n-somerset.gov.uk/BGH** or call 0117 352 1180 to speak to the Bristol City Leap team.

Together with the other councils, North Somerset Council successfully bid for £11m government funding to help local households install technologies which reduce carbon emissions and lower energy costs.

The criteria for eligibility were established by the government's Department for Energy Security and Net Zero (DESNZ).

Read more about actions you can take to help tackle the climate emergency from page 26.



Find a job in children's social care

Would you like a job that makes a difference to the lives of children and young people in North Somerset?

A new website has launched to make it easier to find jobs in children's social care.

North Somerset Council has worked with Jobspublic, the national jobs board dedicated to serving the public sector, to create a new microsite specifically promoting job vacancies within its children's support and safeguarding teams.

The website includes more information about the team, salary and benefits on offer, and what makes North Somerset a great place to live and work.

Visit the new website at www.n-somerset.gov.uk/childrensocialcarejobs



Promoting wellbeing in older people

New Tai Chi QiGong sessions are launching in North Somerset to enhance wellbeing and independence of older people.

Local charity Age UK Somerset is expanding its Ageing Well service and is launching these new classes locally.

QiGong, pronounced 'chee gung', is a form of Tai Chi that is beneficial to both physical and mental wellbeing.

It consists of 18 gentle movements and is specially designed for people aged over 55.

Classes are being held across North Somerset including in Bleadon, Kewstoke, Nailsea, Portishead, Weston, and Worle.

An outdoor class in Weston-super-Mare has also launched, as well as an online class for those who can't get out.

These classes have been set up thanks to new grant funding (see page 8). Classes cost £5 per session (£4 online) and cater for all levels and experience.

Find out more by calling 01823 345 624 or email ageingwell@ageuksomerset.org.uk



New council make up

Local elections took place in May and a partnership administration was formed to run North Somerset Council, after no single party gained enough seats for a majority.

Read more about the political make up of the council from page 30.

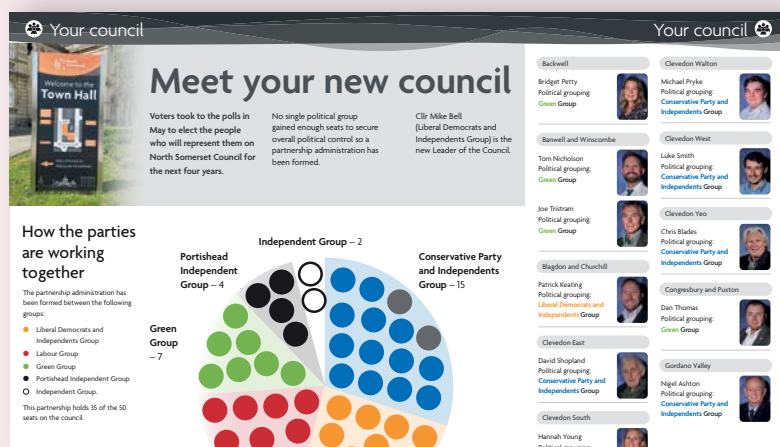

Ensuring communities are at the heart of public health

Community and voluntary groups in North Somerset have been awarded thousands of pounds in funding to run local projects that improve health and wellbeing.

Funding has been awarded to projects addressing mental health, social prescribing and for community food projects, helping to improve the wellbeing of people across North Somerset.

Community groups are valuable because they help people connect, create resilient and more cohesive communities, engage with those at most risk of poor health, empower people to have a greater say in their lives and health, and help to reduce health inequalities.

Six existing and new community food projects have received a share of £30,000 to encourage nutritious and affordable food choices, healthy eating and to improve food knowledge and skills.

These include:

- Boombox Youth Projects – young people aged 11 to 18 have been learning how to cook healthily.
- Brown Rock Community Garden – weekly gardening sessions where participants learn to grow their own food, such as fruit and vegetables.

- Pill Youth Club – cooking and growing sessions, learning what's in season and within budget.
- Theatre Orchard – solidarity suppers, bringing together members of the refugee and asylum seeker communities to share recipes and cooking skills, along with social events.
- Weston Foodbank - self-help cookery courses, helping those in food poverty.
- XTND: Improving Futures - parent and child cooking group, taking place in local primary schools.

For more information about health and wellbeing activities across North Somerset visit www.betterhealthns.co.uk



A vision for North Somerset

Local elections took place in May and work is now under way to develop a new corporate plan for North Somerset Council.



This is the council's over-arching strategic plan and will drive council priorities over the next four years.

It informs everything the council does and sets out the vision, aims and priorities, and the actions needed to achieve them.

The plan will be developed in draft over the coming months and there will be an opportunity for the community to get involved in shaping it.

There will be more information on how to get involved in the next edition of *Life*.

Other ways to have you say

Speak at council meetings

Any resident, business ratepayer or person entitled to vote in North Somerset can request a slot to speak at council meetings.

This might be Full Council, the Executive, the planning and regulatory committee or policy and scrutiny panels.

Find out more at www.n-somerset.gov.uk/how-speak-council-meetings, email committee.administration@n-somerset.gov.uk or call 01934 634 900.

Comment on consultations

All consultations run by North Somerset Council are listed at www.n-somerset.gov.uk/consult

If you register on the site you can opt-in to receive a weekly email about any new consultations.

If you haven't got internet access at home, posters are put up in libraries every month listing current consultations and contact details, including a phone number.

Public notices

Public and legal notices can be viewed online at www.n-somerset.gov.uk/notices

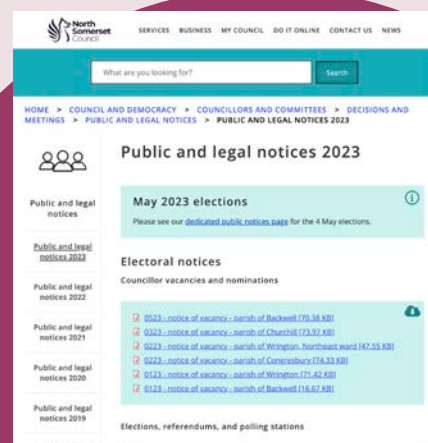



Get set for the summer season



Summer is upon us and now is the perfect time to explore what's on our doorstep.

North Somerset has always attracted millions of visitors every year, with its beautiful coast and countryside and lively and diverse events calendar.

In the coming months there are outdoor theatre performances, food festivals, music, comedy and more for all the family to enjoy.

Many events are free to attend but the summer season is also hugely important to North Somerset's economy, so please support local businesses and organisations if you can.

Read on to see a snapshot of what's happening but please check with organisers nearer the time to confirm details.

For the most up-to-date listings, go online:

www.discovercleveland.co.uk

www.nailseatown.com/whats-on

www.visitportishead.net

www.visit-westonsupermare.com

Also see the latest announcements on social media:

@discovcleveland

@visitportishead

@westonseafont

@theatreorchard

@cultureweston



Disclaimer: All information correct at time of going to print (June 2023). While every effort is made to ensure accuracy, North Somerset Council cannot accept responsibility or liability for any errors which have occurred. North Somerset Council cannot recommend or endorse any of the providers listed. It is recommended that you always check with the relevant organisation first to ensure their service meets your requirements.

Cultivating culture and creativity

Culture and the creative arts continue to play a prominent role in Weston-super-Mare, as the town builds on its growing reputation as an arts destination.

As part of this, arts organisation Culture Weston is hosting a series of free events throughout the summer.

Colourful stage is set



Free outdoor events will make a colourful line-up at Weston's vibrant landmark bandstand.

The eye-catching performance stage, in the High Street, will host music by The Lipinski Band, Sea Shanties, poetry from Rhyme Against the Tide and performances by Ramshaklicious during the summer.

Super Wonder Shrine is part of 21st Century super Shrines, a pioneering heritage project managed by Culture Weston in collaboration with North Somerset Council.

It has been established as part of the four-year High Street Heritage Action Zone (HAZ) cultural programme, funded by Historic England, in partnership with Arts Council England and the National Lottery Heritage Fund.

Youth and family sessions



Children and adults alike have the chance to get their creative juices flowing.

A summer drama course, Youth Theatre taster workshop, and family drama sessions in local libraries, all take place over the coming months.

Festival of outdoor arts returns



Expect high-flying thrills and extraordinary acts when the award-winning Whirligig Festival returns.

The popular free event takes place in the Italian Gardens on Saturday 9 and Sunday 10 September.

It features a high-octane programme of theatre and dance, a climate carnival, plus artist Luke Jerram's work Crossings will offer moments of reflection on Marine Lake throughout the weekend.

Exploring the environment and natural world



Weston-super-Mare's unique coastal landscape will be the focus of a new multi-disciplinary showcase in the town.

PROMENADE, running from Friday 15 to Sunday 17 September, is a new project by Weston-based creative producer and artist Sam Francis.

The programme will explore the ecology of place and our relationship with the environment we live in through artworks, happenings, workshops, walks, talks, film and music.

Visit www.cultureweston.org.uk/whats-on for details of all these Culture Weston events.





Summer events

Music and arts

Weston Wallz

Local, national and international artists have created unique large-scale murals on walls of prominent buildings across Weston.

www.cultureweston.org.uk/weston-wallz



A selection of the Weston Wallz murals

Various dates

Garden Grooves free concerts

Grove Park Bandstand, Weston-super-Mare

A summer of music, organised by Sprout Café.

[search for Sprout Café Weston for events](#)



Various dates in July and August

Front Room Theatre

Dolphin Square, Weston-super-Mare

Weston's newest fringe theatre is hosting a wide variety of performances, including absurd comedy sketch shows and musical storytelling.

www.ticketsource.co.uk/frontroomwsm

Saturday 15 July

Party On The Green

Coniston Green Park, Weston-super-Mare

A free afternoon of fun-filled experiences and activities for all the family, including music, performance and arts.

Saturday 22 July

Outdoor performance of Romeo and Juliet

Tyntesfield, Wraxall

Outdoor theatre production of the classic Shakespeare play, performed by the Lord Chamberlain's Men.

www.nationaltrust.org.uk/tyntesfield

Friday 28 July

Gary Davies

Tropicana, Weston-super-Mare

Party along to your favourite 80s anthems with legendary DJ Gary Davies.

www.tropicanaweston.co.uk

Friday 4 – Sunday 6 August

Weston Sea Shanty and Folk Festival

Venues around Weston-super-Mare

Pirate crews are invading Weston for a free three-day folk festival.

www.wsmshantyfest.com

Saturday 12 August

Neville Staple from The Specials

The Tropicana, Weston seafront

See the legendary front man of The Specials, Fun Boy Three and Special Beat performing hits from his 40-year career.

www.tropicanaweston.co.uk

Friday 25 August

Ultimate Coldplay

Tropicana, Weston-super-Mare

All the Coldplay hits and more, with an amazing look and sound-a-like front man.

www.tropicanaweston.co.uk

Saturday 9 September

Café Mambo Ibiza Classics on the Beach

2pm-10pm, Weston beach

Feel good classics from the Ibiza golden era.

www.skiddle.com/e/36305571

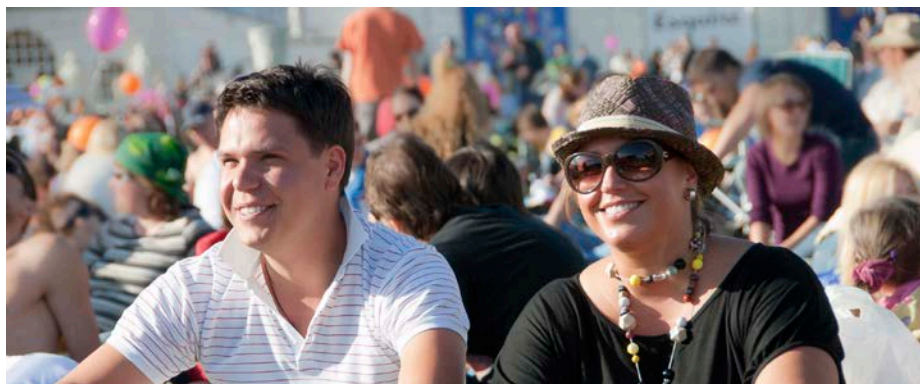



Food and drink

Friday 7 - Sunday 9 July

Somerset Street Food Festival
Portishead Lake Grounds

Friday 7 – Sunday 9 July

Nailsea and Backwell Beer and Cider Festival

Nailsea and Backwell RFC, West End Lane, Nailsea

Booking in advance recommended.

www.nailseabeerandciderfestival.co.uk

Friday 28 – Sunday 30 July

Weston Lions Real Ale and Cider Festival

Beach Lawns, Weston-super-Mare
www.westonlionsrealalefestival.co.uk

Saturday 12 August (Portishead)
and Saturday 23 September
(Weston-super-Mare)

eat:festivals

Local food and drink producers and free entertainment.

www.eatfestivals.org



Movement and sport

Every Thursday until 14 September,
6pm

Weston Bike Nights

Beach Lawns, Weston-super-Mare

Hundreds of motorbike riders descend on the seafront to show off their wheels and raise money for charity.

Every Sunday until 24 September,
9.30am

Free park yoga

Ellenborough Park West, Weston-super-Mare

No booking required, just turn up
www.parkyoga.co/weston

Saturday 8 July (SwimRun) and
Saturday 22 July (Long Swim)

Clevedon Marine Lake

Two popular water sports events.
www.clevedonopenwater.uk/events

Sunday 23 July

Great Weston Ride

A 57-mile challenge bike ride from Bristol to Weston-super-Mare, through the Mendips and Somerset Levels.

www.greatwestonride.com

Friday 11 – Sunday 13 August

Beach Rugby and Netball Festival

Weston beach

Men's, women's and mixed teams from across the UK will be playing rugby and netball.

www.westonbeachrugbyfest.co.uk

Friday 22 – Sunday 24 September

Weston Beach Race

Weston seafront

The UK's biggest off-road motorsport event.

www.rhlactivities.com



Summer fun across North

Markets, festivals, flower shows and more are happening in local communities across North Somerset this summer.

Here is a selection of events taking place over the coming months but check with organisers nearer the time to confirm details.

General interest

Saturday 8 and Sunday 9 July,
10am-5pm

Woodspring Wings Model Aircraft Show

Claverham Drove, Yatton

The biggest model aircraft show in the South West.

www.woodspringshow.co.uk

Sunday 9 July

North Somerset Model Show

Helicopter Museum, Locking,
Weston-super-Mare

More than 120 exhibitors, with model workshops, open cockpits, charity stalls and trade stalls.

www.helimuseum.com

Saturday 22 July, 2-4.30pm

Yatton and District Horticultural Society Summer Show

Yatton Village Hall.

www.yattonhorticulturalsociety.co.uk

Saturday 29 (11.30am-5.30pm) and
Sunday 30 July (10.30am-5.30pm)

Portishead Summer Show

A combination of a traditional flower and produce show and country fair.

www.portisheadsummershow.com



Thursday 3 – Sunday 6 August

Weston Dairy Festival

Beach Lawns, Weston-super-Mare

Animal shows, a petting zoo, craft fair, food market, live music.

www.dairyfestival.co.uk

Saturday 5 August

Nailsea Horticultural Society Summer Show

Nailsea School, Mizzymead Road

www.nailseahorticulturalsociety.co.uk

Sunday 6 August and Sunday 3
September, 10am-2pm

Clevedon Sunday Market

Around the seafront, Hill Road and
Alexandra Road.

www.theclevedonsundaymarket.co.uk

Thursday 10 – Sunday 13 August

Bristol International Balloon Fiesta

Ashton Court

Hot air balloons, trade stands,
fairground rides and entertainment

www.bristolballoonfiesta.co.uk

Saturday 13 August (tbc)

Weston-super-Mare Horticultural Society Flower Show

www.wsmhorticultural.org.uk

Saturday 19 August

Tickenham Flower Show

Noon, Tickenham Village Hall and
field

Flowers, fruit and veg, art, wine
making and more.

www.tickenham.org

Saturday 26 August, noon-6pm

Trendlewood Community Festival

Golden Valley School, Nailsea

Live music, children's activities,
farmers' market, vintage tea tent.

www.tcfnailsea.org.uk

Saturday 26 (noon-6pm) and
Sunday 27 August (9am-5pm)

Clevedon Flower Show

Salthouse Fields
In aid of Children's Hospice South
West.

www.clevedonflowershow.com

Saturday 2 September, 7.30pm

Hutton Big Bash

St Mary's Field.

An evening of live music, food and
drinks.

www.ticketsource.co.uk/hutton-dabaso-twinning-association



Somerset

For the young and young-at-heart

Now until Sunday 3 September

Shaun the Sheep augmented reality trail

Noah's Ark Zoo Farm, Wraxall

Download a free app for the Hide and Sheep trail and find 11 Shaun the Sheep markers around the zoo.

Now until Sunday 3 September

Funland Theme Park

Tropicana, Weston seafront

[f funlandthemepark](#)

Saturday 22 and Sunday 23 July

Dino Weekend

Helicopter Museum, Locking, Weston-super-Mare

Live dino shows, interactive 3D displays, dinosaur petting zoo and more.

www.helimumuseum.com

Wednesday 26 July, 2.30pm

Free outdoor performance

Queens Square, Clevedon

The Last Baguette – a gallop through Greek mythology featuring physical comedy, live music and un-Apollo-getically bad puns.

Ages 6+. Free show funded by Clevedon Town Council.

www.theatreshop.org.uk/shows



Saturday 29 July and Sunday 30 July, 11am and 2pm

Kid Carpet and the Noisy Garden Centre

Front Room Theatre, Dolphin Square, Weston-super-Mare

Catchy songs, puppetry and video magic.

www.frontroomwsm.com/whats-on



Every Wednesday, 2 – 30 August

Magic at The Museum

Helicopter Museum, Locking, Weston-super-Mare

Live magic shows, balloon modelling and slight-of-hand illusions. Different activities each week.

www.helimumuseum.com

Friday 4 (Clarence Park, Weston) and Friday 11 August (Portishead Lake Grounds) 1.30pm-4.30pm both days

Party in the Park for children in the Holiday, Activities and Food (HAF) programme

Free community activities, with balloon modelling, sports and games, facepainting, learn some circus skills, puppet shows.



Friday 11 August, 6.30pm

The Wizard of Oz with Immersion Theatre

Tyntesfield, Wraxall

A magical family show of the classic story.

Booking essential. Call 0333 666 3366

www.nationaltrust.org.uk/tyntesfield

Saturday 19 and Sunday 20 August

Stars of Time Comic Con

Tropicana, Weston-super-Mare

Celebrity guests, traders hall, cosplay, competitions, costumed characters, movie cars, displays and more.

www.tropicanaweston.co.uk

Ride your way through summer



Warmer weather and longer days provide the perfect opportunity to use pedal power as a way of getting around.

North Somerset boasts a host of traffic-free routes providing the ideal way to get to events, pop to the shops, commute to work or explore the countryside.

Key cycling routes include:

- **Strawberry Line Path** – starts at Yatton train station, with bike hire available from Strawberry Cycles, to Cheddar. Visit www.strawberrycycles.com
- **Festival Way** – Nailsea to central Bristol
- **River Avon Trail** (also known as the Pill Path) – this stone path runs from Pill/Ham Green to the Cumberland Basin and is most comfortable on a mountain bike.

- **Brean Down Way** – a 20mph zone has been introduced in Uphill to make this otherwise traffic-free route from Weston to Brean seafront stress-free. From here you can continue on road (or beach, with a mountain bike) to Brean Down. Hire a bike from www.ebikeufo.co.uk, based in The Sovereign, Weston, or from www.breanbikerehire.co.uk

- **The Pier to Pier Way** – a new 13-mile cycle route linking Weston-super-Mare and Clevedon. It is aimed at commuters, leisure users and tourists and will open this year. For updates visit www.n-somerset.gov.uk/piertopierway



Cycle routes also run through towns to give easy access to work or shops, such as route 33 through Weston-super-Mare and route 26 in Portishead.

As well as offering a carbon-free way to travel, cycling also provides a great way to get active, which has physical and mental health benefits.

If you don't own a bike but would like to give cycling a go then you can borrow a bike.



Visit www.n-somerset.gov.uk/cycling to find out more about the borrow a bike scheme and other information including route maps.

Printed copies of the North Somerset cycle map can be picked up from libraries, sports centres and community centres, as well as cycle and independent shops near key cycle routes.

Free-to-use outdoor bicycle pumps are located at train stations and other key locations (shown on the cycle map) across North Somerset if your tyres need a top up.

If you are visiting a leisure centre, North Somerset Council has recently installed secure cycle lockers outside Strode (Clevedon), Parish Wharf (Portishead) and Hutton Moor (Weston-super-Mare).

Lockers are free of charge and anyone wanting to use them just needs to pop into reception for a key.

Hesitant cyclists or those new to riding a bike may also benefit from training.



Cycle training is about improving your skills and awareness and will help you feel more confident and be safe on the roads. It is recommended for all cyclists.

Bikeability courses for children are offered through schools and those that miss out can attend holiday courses organised by Life Cycle UK.

Visit www.lifecycleuk.org.uk/learn

Both Life Cycle UK and Strawberry Cycles also offer one-to-one adult lessons for traditional and e-bikes.

Additional information on how to get started cycling, including training opportunities as well as detailed maps and pump locations can be found at www.betterbybike.info

Extra funding for active travel

Cycling, walking or wheeling across North Somerset will be made easier thanks to more than £400,000 of funding.

North Somerset Council has secured the money from Active Travel England to go towards improving pedestrian and cyclist crossings over roads, safety improvements on routes to schools and opening a new section of the Strawberry Line.

A number of crossings will be improved by reducing the waiting time at priority locations across the area, providing a new zebra crossing on a route to school in

Weston-super-Mare, and safety improvements to some of the Festival Way's junctions.

Funding has also been received to make safety improvements outside several schools through the provision of 'School Streets', and to provide a small but key section of missing link which will open up the Strawberry Line in Yatton North End and help link into the upcoming Pier to Pier Way route from Weston to Clevedon.

The Pier to Pier Way, which opens this year, includes a new one-mile traffic-free route crossing the River Yeo.

This means pedestrians, cyclists and equestrians will be able to avoid the busy A370 and save four miles on their usual journey.



On-demand buses proving popular



Funded by
UK Government

WESTlink

Innovative new on-demand buses are now providing useful transport links for people across North Somerset.

WESTlink launched in April as 'demand responsive transport', meaning buses go where they're needed without a set timetable or route.

People have been using it as a stand-alone service to get to college, work, shops and the cinema, as well as connecting to the wider public transport network for onward travel.

Smaller vehicles are used so they can go to areas which were previously inaccessible to larger buses, meaning communities that had been without a local bus service now have new opportunities to travel.

Wendy Clegg, from Clevedon, said: "I was desperate to get to Dundry for an event but there was no easy transport links from Clevedon.

"I downloaded the WESTLink app the day before. I'm not a confident smartphone user but it was easy.

"I had a text that night confirming my booking, then another the next morning with an approximate pick-up time.

"The bus picked me up and we had a lovely, comfortable ride.

"It was very easy, with reassuring texts, a good app and friendly driver. I will be happy to book the WESTlink bus again and again."

WESTlink buses run Monday to Saturday, from 7am to 7pm (except public holidays).

Journeys can be booked through an app, website or phone, either when you need it or the day before.

Ways to book:

- through a free app – search for WESTlink and download the app through the Apple App Store or Google Play
- phoning the call centre on 0117 457 8561, charged at local rates
- visit www.westlink.app

Tracking software means you can see exactly where your bus is and when it will get to you.

You could also ask to be picked up or dropped off somewhere that doesn't have a physical bus stop, such as a doctor's surgery, pharmacy or local shop.



To request a new virtual stop email westlink@westofengland-ca.gov.uk

A single fare for any journey length within the operating zone is £2 for adults and £1 for children*.

All concessionary and older person's bus passes are accepted.

Pay with a credit or debit card via the app, or pay the driver in cash with the exact change.

Buses plays a key part in North Somerset Council's response to the climate

emergency, as transport makes up 40 per cent of North Somerset's greenhouse gas emissions.

The council is working with the West of England Combined Authority to help make bus travel the first choice over car usage.



It hopes bus travel will become faster, more convenient and co-ordinated, and better for your pocket than running a car.

WESTlink has been launched as part of the Bus Service Improvement Plan.

North Somerset Council was awarded almost £48m in capital funding from the Department for Transport last year to improve bus services over the next three years.

There is also a pooled revenue fund of £57.5m shared with the combined authority.

Find out more about the Bus Service Improvement Plan at www.n-somerset.gov.uk/bsip

See where WESTlink operates at www.travelwest.info/journey-planner, by clicking on the WESTlink button in the pop-up box.

Find out more at www.n-somerset.gov.uk/westlink

Everyone in North Somerset can enjoy free bus travel throughout the month of their birthday.

The initiative, funded by the government, launches this month and aims to show how bus travel can be a more appealing option by giving people the chance to try it for free.

The year-long promotion is available on all local bus services in the West of England, including WESTlink. Happy birthday!



More ways to travel by train or bus

Bus and train routes across North Somerset have been enhanced to make it easier for people to travel sustainably.

North Somerset Council is working with local operators to improve bus services across the area.

Recent changes include:

- a new stop at Worle train station for the A3 (Airport Flyer). An hourly service, 22 hours a day
- a new X10 service linking Clevedon, Weston-in-Gordano, Portishead and Cribbs Causeway, with three round trips Monday to Friday and four on a Saturday
- X1 Bristol to Weston now runs every 15 minutes
- X4 Bristol to Portishead now runs every 20 minutes
- X5 Portishead to Weston now has additional journeys plus the introduction of a weekend service
- X6/7 Bristol to Clevedon now has additional early and late journeys
- X8 Bristol to Nailsea/Backwell has been reintroduced
- W3/7 around Weston now has additional evening journeys.



The government also recently announced the £2 bus fare cap (£1 for children up to 16) has been extended until the end of October.

Great Western Railway recently unveiled a new timetable which has increased the frequency of local train services. Visit www.gwr.com

For 'how to' guides, journey planning, timetables and live departures visit www.nationalrail.co.uk for trains and www.travelwest.info for buses.

*correct at time of Life going to print.

Nailsea Library's new home

Popular Nailsea Library is moving into its new home – securing its long-term future for generations to come.



The new space in Colliers Walk

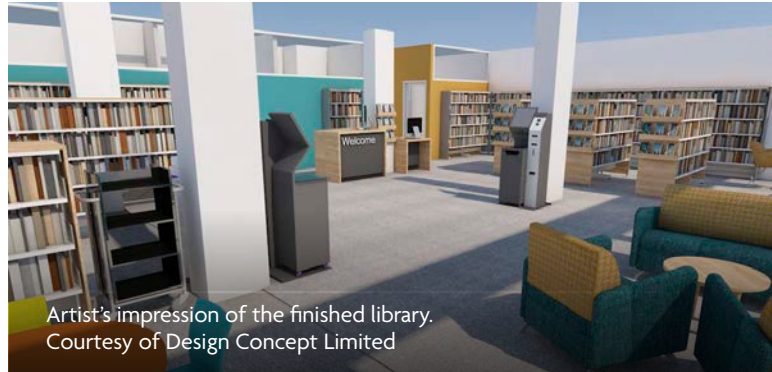

Artist's impression of the finished library.
Courtesy of Design Concept Limited

The library is moving from its original location in Somerset Square into Colliers Walk, in the unit formerly occupied by HSBC bank, after North Somerset Council signed a 125-year lease on the new site.

At the time of *Life* going to print, it was hoped the move would be completed by early summer.

The move forms part of the council's strategy to have modern, accessible libraries where people can enjoy a variety of services.

These include:

- free access to computers, the internet and digital support
- hosting community support and advice sessions
- providing activities for families and people of all ages
- providing access to more than 2.5 million items through the LibrariesWest consortium.

The former 50-year-old building in Somerset Square is beyond its end of life.

It is in poor condition, in need of repairs to the roof because of regular flooding, and is very energy inefficient. It also doesn't meet modern accessibility standards.

Digital facilities are also being improved at both the new Nailsea Library and Portishead Library, thanks to £30,545 government funding from the UK Shared Prosperity Fund.

The funding is helping to set up Extended Access in Nailsea. Registered users will be able to visit the library to borrow books and use the computers and wifi outside of staffed hours when the service launches this autumn.

In Portishead, the funding has been used to install a Nook pod, where people can study and work online, have one-to-one-meetings and charge devices.

North Somerset Council is continuing to investigate options for the future of the former Nailsea library site.

This will tie in with the council's emerging placemaking strategy for Nailsea, which is a vision of building a contemporary identity and renewing the town centre as a destination.

The council is working with owners of the surrounding land as well as Nailsea Town Council. Find out more at www.twotowns.place



The Nook pod in Portishead Library

Read the latest news about Nailsea Library at www.n-somerset.gov.uk/nailsealibrary

Find out more about Extended Access at www.n-somerset.gov.uk/extendedaccess

Find out about the UK Shared Prosperity Fund on page 36.

On your marks for Summer Reading Challenge

Get set for the popular Summer Reading Challenge returning to North Somerset libraries this month.

This year's theme, Ready, Set, Read!, is designed with the Youth Sports Trust and aims to inspire children to get active and involved in sport as well as enjoy reading.

Summer Reading Challenge 2023

**Ready,
Set,
Read!**

Presented by The Reading Agency.
Delivered in partnership with libraries.

Image credit:
Ready, Set, Read!
logo artwork by
Lizzie Everard and
© The Reading
Agency 2023

The free challenge is suitable for four to 11-year-olds and starts on Saturday 8 July.

Children will receive a reward for every book they read. If they read six by Saturday 9 September, they'll receive a certificate and medal (while stocks last).

Libraries will also be running sports-themed activities to keep children busy throughout the summer.

Discover what's on at your local library at www.n-somerset.gov.uk/libraryevents



Learn a new language for free

Would you like to learn a new language for work, travel or fun?



More than 110 languages are available to learn for free thanks to a new online platform for North Somerset library members.

Transparent Language Online offers bitesize courses in languages for popular holiday destinations, as well as Ukrainian, Arabic, English for speakers of other languages, and many more.

The service has been funded by North Somerset Council's refugee resettlement team to encourage the people they work with to improve their spoken and written English skills, but it's available to all North Somerset library members.

Find out more at www.n-somerset.gov.uk/onlinelibrary

Discover your family history

Family history enthusiasts can now explore the 1921 Census on library computers.



Find My Past is a searchable online archive of more than 13 billion records, featuring everything from parish, school, census and migration records to military collections from across the globe.

Find My Past is only available in the North Somerset Studies Library, at Weston library.

However, all library computers have access to the family history research site Ancestry.



For the latest updates from the library service follow the team on social media:

-  [nslibraries](#)
-  [NSomLibraries](#)
-  [northsomersetlibraries](#)



Could you enjoy a sober summer?

Long summer evenings are on the horizon and it can be tempting to enjoy a tipples while relaxing and enjoying the warmer weather.

Drinking alcohol is often associated with having a good time but the odd glass of wine or pint of beer can quickly escalate to two or three glasses on most days.

Men and women are advised to limit their drinking to no more than 14 units of alcohol a week – the equivalent to six pints of average strength beer, or nine small or seven standard glasses of average strength wine.

Regularly drinking more than this can harm your health, including increasing your risk of cancer and liver disease as well as weight gain.

Reducing your alcohol intake can have a major impact on your life, improving your physical and mental health both in the short and long-term.

It results in less hangovers, better quality sleep, weight loss and improved mental wellbeing, as well as being good for your pockets as you start to save money.

North Somerset Council is working with other organisations in the North Somerset Combatting Drugs Partnership to try and reduce the harms caused by substances, including alcohol, and is commissioning services to support people to drink less.

If you're thinking about cutting down your alcohol consumption, the Better Health North Somerset website has lots of useful tips and advice.

There are details of how to contact the council's healthy lifestyle advisers, who can give free advice on how to form healthier habits and reach healthy lifestyle goals, including drinking less alcohol.

Find out more at www.betterhealthns.co.uk/drink-less

Top tips for drinking responsibly this summer

- Have several drink-free days each week.
- Tell your friends and family you're cutting down and that it's important to you – they could support you.
- Make it smaller – still enjoy a drink but have smaller sizes. Try bottled beer instead of pints or a small glass of wine instead of large.
- Drink lower-strength – swap strong beers or wines for those with a lower strength (ABV in %).
- Stay hydrated – drink a glass of water first and then alternate alcoholic drinks with non-alcoholic ones.
- Try alcohol-free alternatives, such as 'No-secco' and 'virgin cocktails'.



Protecting people on Weston's beach

Dedicated seafront rangers work 365 days a year to help keep Weston-super-Mare's beach safe for everyone.

The rangers are trained to deal with a wide variety of incidents and are usually the first on the scene to deal with any accidents and emergencies.

Joe Webber leads the team of three. He said:

"We're on-hand to keep the beach a safe, clean and pleasurable place to be."

This means carrying oxygen and defibrillators to treat any life-threatening emergencies, to dealing with anti-social behaviour issues such as littering or public disputes.

Between March and September last year the seafront rangers assisted with eight landings of the air ambulance, 69 missing persons reports, 67 minor to major first aid incidents, and 81 calls from the coastguard emergency control room to observe or rectify incidents, or to request back up from emergency services.

The team are trained first responders and have recently undergone mental health training to deal with the increased number of mental health incidents they now face.

Joe said: "The ranger team are a credit and a lovely group of individuals. I am so proud of them."

During high tides, the rangers work with other council officers to shut all necessary flood gates along the seafront.

They also undertake a number of natural environment tasks, such as monitoring and recording sand levels to help the flood risk management team.

In winter months, the rangers do a variety of maintenance work to keep the seafront looking great, as well as being safe, and are on standby to help clear up any storm damage.



How to stay safe on the beach

Always check tide times before you head out. Visit www.n-somerset.gov.uk/tidetimes

Never walk out to the sea when the tide is out due to the sinking mud and extremely fast incoming tides.

If anyone is in danger to call 999 and ask for the coastguard.

For events and up-to-date information follow Weston Seafront on social media.

 [westonseafont](#)
 [westonseafont](#)
 [westonseafont](#)



Stroll along the Strawberry Line



This family-friendly route is a circular stroll along the Strawberry Line from Yatton to Congresbury.

Walk information

Distance: about 3.5 miles

Difficulty: easy – level paths, plus a few fields with kissing gates

Estimated time: about 2 hours

Map: OS Explorer 154

Refreshments at the Strawberry Line Café, at Yatton train station, open 8am-4pm Mon-Fri and 9am-4pm Sat/Sun. More options in Congresbury and Yatton.

How to get there

The walk starts at Yatton train station. Regular trains from Weston-super-Mare and Bristol.

The car park costs £2.70 Monday-Friday, £2 Saturday and Sunday, for all day.

Community cycle hire also available at the station. Visit

www.strawberrycycles.com

Find out about public rights of way in North Somerset at www.n-somerset.gov.uk/publicrightsofway

Start the walk at Yatton train station, a Grade II listed building dating from 1841.

Walk to the end of the car park next to platform one (trains bound for Weston-super-Mare), and the start of the Strawberry Line path.

The path follows the former Cheddar Valley Railway line, built in 1869. It was known as the Strawberry Line because of its cargo from the strawberry fields of Cheddar.

Despite being a busy junction, it closed in 1965 and a wealth of wildlife habitats then flourished.

The line now forms part of a nine-mile almost traffic-free National Cycle Network route, number 26.

Information boards give details of the area's history and what to look out for.

Benches are installed at regular intervals, including a mosaic seat made by pupils of Yatton Junior School in 2000 to celebrate Roman remains found nearby.



The railway was built over Congresbury marsh, which was drained in 1819 when the present rhynes (small ditches) were built.

The path will come to a rhine so cross over the small bridge here and then head immediately left down Moor Lane.

Walk towards the A370. Before crossing the bridge over the River





Yeo, go through the kissing gate on your left-hand side and into the field.

This is a well-used permissive path which crosses three small fields. Keep dogs on leads here and follow the edge of the river. Congresbury will be ahead of you.

Before entering the final field, veer to your left towards the gap in the trees/hedge.

Continue on through the field towards the houses and you'll reach another kissing gate leading out onto the B3133.



Head left up this road for about a quarter of a mile, passing Cadbury Garden Centre on the other side of the road, until you get to The Pet Studio dog kennels.

Take the track on your left, just after the kennels.

Follow this track for about a quarter of a mile and there is a kissing gate in the hedge on your right-hand side (if you get to the farmhouse you've gone too far).

Walk left around the edge of the field towards the top corner. There is a wide gate with a kissing gate next to it. Go through here, and continue ahead across the next field, keeping to the right-hand edge next to the trees.

Go through the kissing gate at the end, with a footpath leading onto Mendip Road.

Turn left onto Mendip Road and cross the road at the corner with Rectory Way.

The public footpath continues behind the garages. At the large stone, go right and follow the footpath behind the houses, which leads to St Mary's Church.

Follow the footpath through the graveyard to Yatton High Street, where you can turn left and head back to the station.

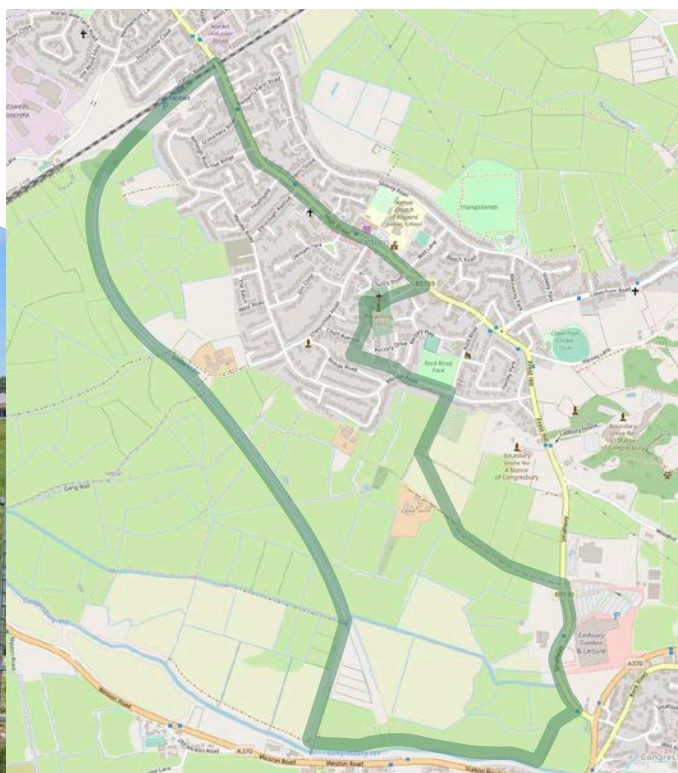

© Crown copyright and database rights 2023 Ordnance Survey 100023397. You are not permitted to copy, sub-license, distribute or sell this data to third parties in any form.



Take action on food waste

Every year in the UK about seven million tonnes – £10bn worth – of food is wasted in homes.

For the average UK family, this means about £700 of food shopping goes in the bin every year.

As well as this being a waste of money, it is also a key driver of climate change.

Huge amounts of land, energy and water are needed for food production; raw materials are needed for packaging; and transportation creates carbon emissions, particularly if the food has been flown-in from far away.

If this food is then not eaten, all those resources required to produce it and get it to your home are worthless.

Dealing with the food thrown away then requires even more resources, including transportation emissions from collection vehicles, as well as energy and water at the processing facility.

Statistics for food waste are staggering. Research from the charity Waste and Resources Action Programme (WRAP) found that every day in the UK we waste 24 million slices of bread, 5.8 million potatoes and 4.4 million apples.

While some of this is unavoidable, such as peelings, cores and bones, the majority is, or once was, perfectly good food.



Follow these simple tips to reduce food waste, increase value for money and cut your carbon footprint:

- eat all edible parts of your food
- check dates and cook food that needs using up first
- have one day a week to use leftover food
- freeze excess amounts and use another day
- serve smaller portions.

How can you help tackle the climate emergency?

1. Reduce food waste

2. Recycle unavoidable food waste – either by home composting (see page 29) or using the council's weekly food waste collection service



Reduce food waste in the first place

Did you know that most foods can be frozen before they reach their 'use before' date?

Most fruit, vegetables, milk, cheese, meat, fish and bread can be portioned up and frozen to be used another day.

Discover simple hacks, tips and guidance to make the most of your food at

www.lovefoodhatewaste.com.

Remember that cutting your food waste will reduce your household's carbon footprint as well as save money on your shopping bill.



Recycling food waste

Eating and enjoying our food is the best thing we can do with it.

For unavoidable waste, it's very important that it's processed in a way which limits its negative environmental impact.

A recent waste analysis in North Somerset found that 27 per cent (almost a third) of the contents of an average black rubbish bin is food waste.

Food waste put into a black bin is not recycled. Instead, it goes to Avonmouth to be burnt at an energy-from-waste plant.

This process creates carbon dioxide, a damaging greenhouse gas, which contributes to climate change.

If you recycle your food waste instead, you'll limit these emissions while also reducing odours and creating extra space in your black waste bin.

There are two ways to recycle food waste in North Somerset – home composting or the council's weekly kerbside collection service.

If you'd like to learn how to home compost, a **free** e-learning Master Composter course is available online.

Find out more at **www.n-somerset.gov.uk/composting**.

For kerbside collections, households are given a small caddy for collecting food waste in the kitchen and a larger food waste box to put outside for the weekly collection.

If your containers are missing or damaged, request more at **www.n-somerset.gov.uk/food-waste**.



Some people living in flats now have access to a communal food waste bin. North Somerset Council is continuing to introduce these across the area.

Food waste collected from households currently goes to an anaerobic digestion plant in Weston-super-Mare to be processed.

The methane released as the food rots down is collected and converted safely into biogas, which is used to generate electricity to power homes.

It also creates a nutrient-rich fertiliser which is sold to local farmers for agriculture and land regeneration.

Please recycle:

- ✓ raw and cooked meat and fish, including bones
- ✓ tea bags and coffee grounds
- ✓ bread, cake and pastries
- ✓ fruit and vegetables, including peelings and cores
- ✓ cooked food and plate scrapings
- ✓ dairy, including cheese and eggs
- ✓ pet food

No thanks:

- ✗ liquids, including milk and oil
- ✗ packaging of any kind
- ✗ tissues



Minimise waste to help tackle

Minimising the amount of waste we create can help tackle the climate emergency.

As a community, we all have a responsibility to reduce the amount of waste we produce.

It not only benefits the environment but also helps to save valuable resources and reduces the cost of waste disposal.

North Somerset Council wants to change the way we all think about waste, to instead see it as a resource to be utilised and its value recovered.

The council's waste strategy was launched early last year and set out some key targets.

These include increasing the recycling rate to 70 per cent and reducing residual waste by 15 per cent from 2019/20 levels by 2030.

Progress is being made on these targets and the full first annual report is available online at www.n-somerset.gov.uk/wastestrategy

Latest figures show that households in North Somerset are still producing more waste now than they did before the pandemic, but this has reduced slightly from when more of us were at home during lockdown.

Residual waste (in kgs per household):

- 2019-2020 – 399.66
- 2020-2021 – 406.83
- 2021-2022 – 405.83

Recycling has gone up significantly in the last year but is still below pre-pandemic levels.

Recycling (tonnage of material diverted for reuse):

- 2019-2020 – 590.39
- 2020-2021 – 375.55
- 2021-2022 – 553.60



Last year, North Somerset Council saw a drop in its overall recycling rate and position in the national recycling league table.

Recycling rate (including garden waste and tonnage from recycling centres)

- 2019-2020 – 60.6 per cent
- 2020-2021 – 60.4 per cent
- 2021-2022 – 59.5 per cent

Recycling league table of all councils in England:

- 2019-2020 – 9th
- 2020-2021 – 7th
- 2021-2022 – 12th

Litter pick in your local area

Volunteers are working together to help keep local areas in North Somerset looking clean.

Organised litter picks are a great way to meet new people and protect your natural environment. If you would like to join in, you could adopt a street or road near to where you live.

The council provides litter picking equipment, safety advice and insurance.

Find out more about Adopt-a-Street at www.n-somerset.gov.uk/adopt-a-street

For one-off events, visit www.n-somerset.gov.uk/litterpicks



Make the climate emergency

Small changes make a **big** difference

General waste in your black bin costs more than £120 a tonne to dispose of.

With more than 31,000 tonnes of general waste collected last year, this quickly adds up.

Small changes can make a big difference. For ideas on how to reduce your black bin waste, visit: www.n-somerset.gov.uk/reduce.



The council's waste minimisation team go out and about around the area to help spread the word at events and workshops.

If an event is happening in your community that you'd like the team to attend, email recycling&waste@n-somerset.gov.uk

Please include the date and time of the event, the location, a description, expected numbers, the target audience, and how you think the team can help.



Get composting and win vouchers



Learn more about composting and be in with the chance of winning a prize by completing a free online course.

The free course, delivered by Garden Organic, is packed with information to help you get the most out of composting, whether you're a beginner or not.

Discover the ins and outs of composting techniques, learn about the fascinating creatures that live in your compost, explore the many ways of using your finished compost, and get answers from the experts to any questions.

Access and complete the free e-learning course at www.n-somerset.gov.uk/composting. Submit your feedback by the end of August to be entered into a prize draw, with the chance of winning either a compost bin or garden centre gift vouchers.

You can also order a discounted compost bin for £10 at www.n-somerset.gov.uk/composting



COMPOSTING LET'S GET DOWN TO EARTH

Follow the recycling team on social media for the latest updates.

 [NSrecyclingandwaste](https://www.facebook.com/NSrecyclingandwaste)  [ns_recycling](https://twitter.com/ns_recycling)





Meet your new

Voters took to the polls in May to elect the people who will represent them on North Somerset Council for the next four years.

No single political group gained enough seats to secure overall political control so a partnership administration has been formed.

How the parties are working together

The partnership administration has been formed between the following groups:

- Liberal Democrats and Independents Group
- Labour Group
- Green Group
- Portishead Independent Group
- Independent Group.

This partnership holds 35 of the 50 seats on the council.

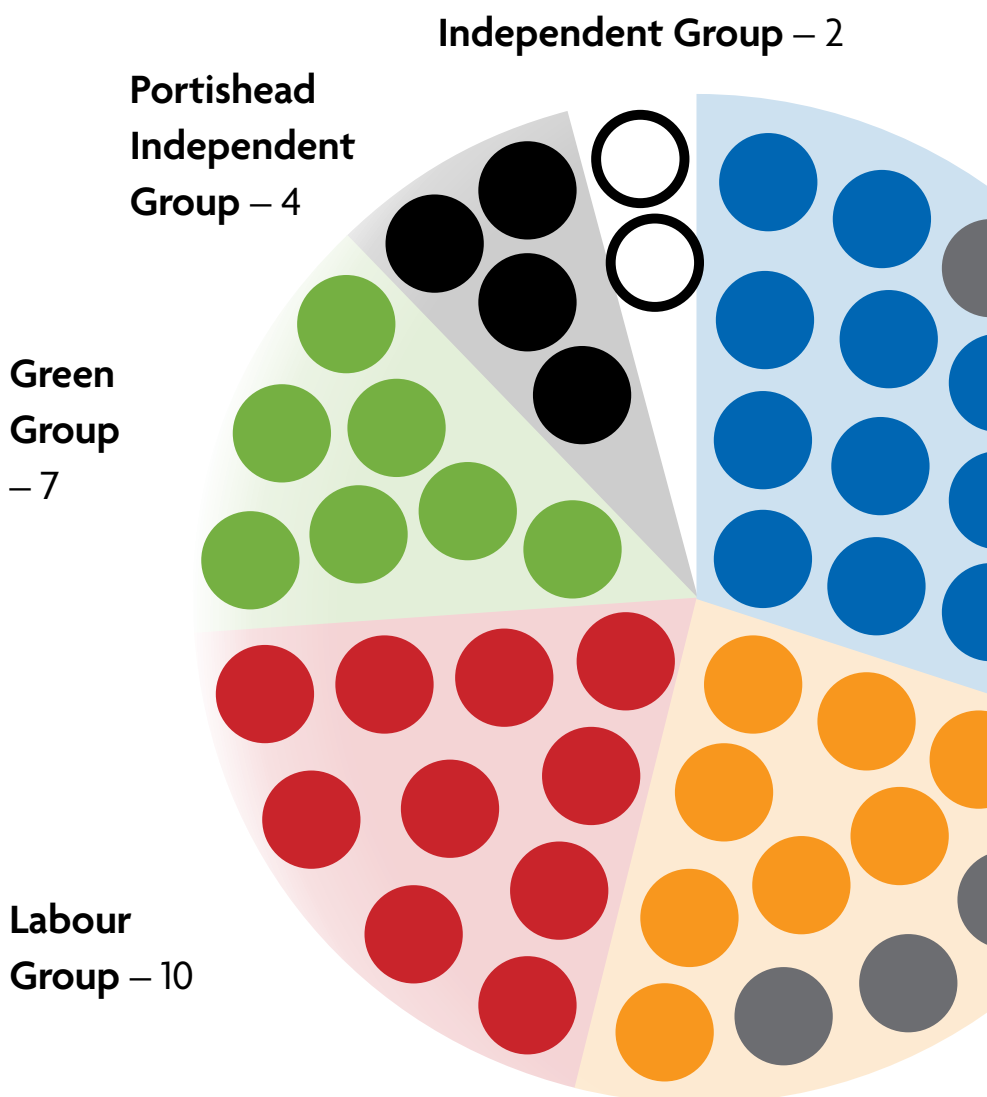

council

Cllr Mike Bell
(Liberal Democrats and
Independents Group) is the
new Leader of the Council.

Conservative Party and Independents Group – 15

Liberal Democrats and Independents Group – 12

Backwell

Bridget Petty
Political grouping:
Green Group



Banwell and Winscombe

Tom Nicholson
Political grouping:
Green Group



Joe Tristram
Political grouping:
Green Group



Blagdon and Churchill

Patrick Keating
Political grouping:
**Liberal Democrats and
Independents Group**



Clevedon East

David Shopland
Political grouping:
**Conservative Party and
Independents Group**



Clevedon South

Hannah Young
Political grouping:
Labour Group



Clevedon Walton

Michael Pryke
Political grouping:
**Conservative Party and
Independents Group**



Clevedon West

Luke Smith
Political grouping:
**Conservative Party and
Independents Group**



Clevedon Yeo

Chris Blades
Political grouping:
**Conservative Party and
Independents Group**



Congresbury and Puxton

Dan Thomas
Political grouping:
Green Group



Gordano Valley

Nigel Ashton
Political grouping:
**Conservative Party and
Independents Group**



Find your local councillor online at
www.n-somerset.gov.uk/councillors

Email councillors using the format
firstname.secondname @n-somerset.gov.uk





Hutton and Locking

Terry Porter
Political grouping:
**Conservative Party and
Independents Group**



Mike Solomon
Political grouping:
**Liberal Democrats and
Independents Group**



Long Ashton

Ash Cartman
Political grouping:
**Liberal Democrats and
Independents Group**



Stuart McQuillan
Political grouping:
Green Group



Nailsea Golden Valley

Andy Cole
Political grouping:
**Conservative Party and
Independents Group**



Nailsea West End

Oliver Ellis
Political grouping:
**Conservative Party and
Independents Group**



Nailsea Yeo

Mike Bird
Political grouping:
**Liberal Democrats and
Independents Group**



Nailsea Youngwood

Clare Hunt
Political grouping:
Labour Group



Pill

Jenna Ho Marris
Political grouping:
Green Group



Portishead East

Roger Whitfield
Political grouping:
**Portishead Independent
Group**



Caritas Charles
Political grouping:
**Portishead Independent
Group**



Portishead North

Timothy Snaden
Political grouping:
**Portishead Independent
Group**



Portishead South

Peter Burden
Political grouping:
**Conservative Party and
Independents Group**



Portishead West

Nicola Holland
Political grouping:
**Portishead Independent
Group**



Sue Mason
Political grouping:
**Liberal Democrats and
Independents Group**



Weston-super-Mare Central

Mike Bell
Political grouping:
**Liberal Democrats and
Independents Group**



Robert Payne
Political grouping:
**Liberal Democrats and
Independents Group**



Weston-super-Mare Hillside

Mark Canniford
Political grouping:
**Liberal Democrats and
Independents Group**



John Crockford-Hawley
Political grouping:
**Liberal Democrats and
Independents Group**



Find your local councillor online at
www.n-somerset.gov.uk/councillors

Email councillors using the format
firstname.secondname @n-somerset.gov.uk



Weston-super-Mare Kewstoke

Lisa Pilgrim
Political grouping:
**Conservative Party and
Independents Group**



Martin Williams
Political grouping:
**Conservative Party and
Independents Group**



Weston-super-Mare Mid Worle

Jemma Coles
Political grouping:
**Liberal Democrats and
Independents Group**



Weston-super-Mare Milton

Richard Tucker
Political grouping:
Labour Group



Catherine Gibbons
Political grouping:
Labour Group



Weston-super-Mare North Worle

Marc Aplin
Political grouping:
**Conservative Party and
Independents Group**



Marcia Pepperall
Political grouping:
**Conservative Party and
Independents Group**



Weston-super-Mare South

James Clayton
Political grouping:
Labour Group



Ian Parker
Political grouping:
Labour Group



Weston-super-Mare South Worle

Hugh Malyan
Political grouping:
Labour Group



Peter Crew
Political grouping:
**Conservative Party and
Independents Group**



Weston-super-Mare Uphill

Helen Thornton
Political grouping:
Labour Group



Peter Bryant
Political grouping:
**Conservative Party and
Independents Group**



Weston-super-Mare Winterstoke

Ciaran Cronnelly
Political grouping:
Labour Group



Annabelle Chard
Political grouping:
Labour Group



Wick St Lawrence and St Georges

Stuart Davies
Political grouping:
**Liberal Democrats and
Independents Group**



Winford

Annemieke Waite
Political grouping:
Green Group



Wrighton

Steve Hogg
Political grouping:
Independent Group



Yatton

Steve Bridger
Political grouping:
Independent Group



Wendy Griggs
Political grouping:
**Liberal Democrats and
Independents Group**





The shape of society in North Somerset

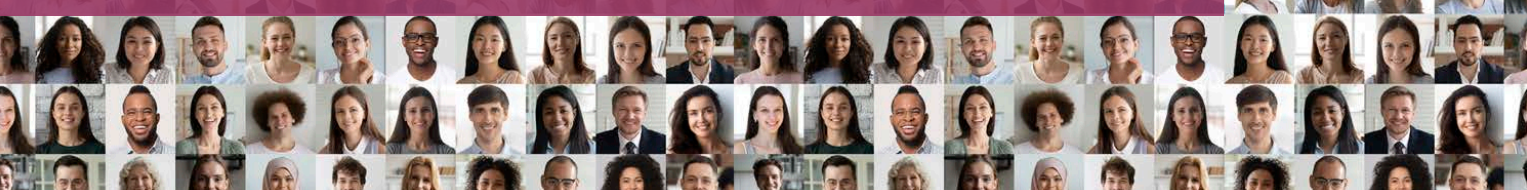

Results from the 2021 census are giving a rich picture of all people and households in North Somerset.

The once-a-decade survey, carried out by the Office for National Statistics (ONS), is the most complete source of information about the overall population that we have.

Information from it gives central and local government, health authorities and many other organisations the data to target their resources more effectively, and to plan for housing, education, health and transport services for years to come.

Across the country, 97 per cent of households responded to the latest census, giving a huge insight into the way we live currently.

Results from the survey are being released in batches, once the ONS has completed its processing and quality assurance.

North Somerset Council has worked with the ONS to give local insight and ensure the best possible statistics for the area.

Here's the overall snapshot of how North Somerset looks:

- The population of North Somerset has continued to grow. On census day there were 216,700 people, compared to 202,600 in the 2011 census.
- The average age on census day was 45.
- Our population profile is different from the national profile. We have a higher percentage of people aged over 65 and a lower percentage of children and young people aged under 19.





Diversity

North Somerset has an increasingly diverse population.

- 8.4 per cent of people were born outside the UK compared to 17.4 in England.
- 5.1 per cent were born in other European countries, compared with 7.2 per cent in England.
- 6.8 per cent of households have members from different ethnic groups, compared with 10.1 per cent in England.
- 4.8 per cent of households do not have English as their main language, compared with 10.7 per cent in England.

Identity

- 45.3 per cent of people do not identify as having a religion, compared with 36.7 per cent in England.
- 46.6 per cent identify as being Christian, and 8.1 per cent identify as other religions or did not answer.
- 90.6 per cent identify as heterosexual and 2.6 per cent as LGB+ (6.8 per cent didn't answer).

- 0.34 per cent have a different gender identity to birth (5.2 per cent didn't answer).

Disability and health

- 83 per cent of people have good or very good health, but 4.9 per cent have bad or very bad health.
- 7 per cent people are disabled (under the Equalities Act), with their day-to-day activities limited a lot, and 10.7 per cent are disabled with their day-to-day activities limited a little.
- 8.8 per cent of people aged over five are unpaid carers, with 2.4 per cent providing more than 50 hours a week of unpaid care.

Work and travel

- 59.7 per cent of people aged over 16 are economically active, excluding full-time students.
- 1.9 per cent are economically active but unemployed.
- Of those that are economically inactive, 28 per cent are retired and 3.6 per cent are on long-term sick leave or disabled.
- 32.6 per cent of people work mainly from home and 30.3 travel less than 10km to work (with 12.1 per cent travelling less than 2km).

North Somerset Council is now analysing the data to better understand the local area and population.

Find out more about what the census is and why it's important at www.ons.gov.uk/census



New initiatives to increase local prosperity

Community organisations, charities, social enterprises and businesses across North Somerset can now access a range of grants and support thanks to funding designed to improve skills and life chances.

North Somerset Council received £2.5m from the government's UK Shared Prosperity Fund (UKSPF) to be used until April 2025 for projects which will empower communities, support local businesses and develop employment and skills opportunities.

The council consulted with local organisations and partners and, as a result, several schemes have been developed.

Here's a round-up of some of what's on offer...

Community grants

More than £200,000 has been distributed to 17 organisations across North Somerset, to deliver arts and heritage work, community engagement schemes, and social action projects, in the first round of the UKSPF community grants programme.

Voluntary Action North Somerset (VANS) supported applicants to apply for these grants by providing free workshops about submitting high quality bids.

Future funding rounds will be coming soon so anyone interested is encouraged to apply.

Find out more at www.n-somerset.gov.uk/ukspfgrants or email policypartnershipteam@n-somerset.gov.uk



Tailored business support

Free one-to-one sessions, workshops, events and ongoing advice are available for businesses looking for support and fresh ideas.

The free Business Support Unlocked programme is being delivered by the hive business centre, in Weston-super-Mare.

Impartial advisers can help those that have decided to start-up or grow their micro, small or medium-sized business.

Find out more or book a session at www.hivebusinesssupport.org or call 01934 418 118.

Business support for not-for-profits

Charities, social enterprises and community organisations in North Somerset can access free targeted business support until next April.

The capacity building scheme aims to provide not-for-profit organisations with skills to increase their sustainability.

Raise Partnership is delivering this programme of targeted support, which could cover bid writing, business planning, governance structure or any other expert guidance.

Many organisations suffer from lack of a suitable site so Raise is also working to suggest empty buildings which could be given a new lease of life.

Raise managing director, Richard Savory, said: "The not-for-profit sector is full of inspirational people.

"We are engaging with so many already, from community singing to teaching English to refugees, to those working within village youth clubs and historic buildings."

Organisations interested in accessing this capacity building support can visit www.innorthsomerset.co.uk/capacity-building or email super-weston@n-somerset.gov.uk or daisydixon@raisepartnership.co.uk

Home energy advice over the phone

Free, impartial advice about ways to save energy around the home and lower bills is available over the phone.

Bristol-based Centre for Sustainable Energy (CSE) offers wide-ranging advice on energy saving measures, accessing grants and benefits, understanding energy bills, no and low-cost energy saving tips, referrals to partner organisations, and advice on renewable energy technologies.

The UKSPF is part-funding the continuation of the freephone home energy advice line, so householders, including those in North Somerset, can speak to advisers for detailed or tailored advice.

Call the advice line on 0800 082 2234, email home.energy@cse.org.uk or visit www.cse.org.uk



Net zero grants available

Small and medium-sized businesses can get support with lowering their carbon footprint through the new Net Zero Business Grants Programme.

Grants of up to £30,000 are available for energy efficiency measures, including LED replacements, draught proofing and air source heat pumps.

Match-funding of up to 70 per cent is available for businesses, depending on the size, location and type of project.

Free carbon surveys are available from this summer, with grant applications going live in January.

For more information visit www.innorthsomerset.co.uk/nzbgp or email business@n-somerset.gov.uk



Employment and training for care leavers

Care leavers up to 25 years of age in North Somerset are working with a UKSPF-funded coach to help identify their strengths and find employment, education, and training opportunities.

Local businesses and organisations are invited and encouraged to get involved with this work.

North Somerset Council can provide bespoke advice to any organisations which can offer opportunities for the supported care leavers.

Email jane.goodison@n-somerset.gov.uk

Find out more about the UK Shared Prosperity Fund at www.innorthsomerset.co.uk/ukspf



The UK Shared Prosperity Fund is key to the government's Levelling Up agenda. In total, £2.6bn is being invested in local communities, businesses, people and skills training to improve pride in places and increase life chances.



Continued help with the rising cost of living

Rising interest rates and high inflation are still a worry for millions of people.

Energy prices will be coming down in July but food prices are still higher than last year and climbing interest rates means we're still paying more for goods and services.

With no end in sight to the cost-of-living crisis, North Somerset Council wants to do all it can to help residents with energy, food, water, transport and housing bills.

Last year a taskforce was set up to respond to the crisis locally, in partnership with key organisations.

A network of community living rooms was established over the winter for residents to stay warm, and the council hosted a cost-of-living event with its partners.

Find a round-up of advice and guidance on the council's website, at www.n-somerset.gov.uk/col

Also follow **#NorthSomersetTogether** on social media channels.

Support for households

A further £2.6m has recently been awarded to North Somerset Council from the government's Household Support Fund to support those most in need in the area.

This is on top of the £4m received in previous years.

The money will be spent supporting the most vulnerable residents, including families with children, pensioners, care leavers, children eligible for free school meals, as well as those 'just about managing'.

It is being distributed through fixed automatic food vouchers to individuals on certain benefits

as well as grants to organisations, including the Handy Person service, Salvation Army, Fuel Bank and Citizens Advice Bureau Surviving Winter grant.

A portion of the funding is allocated to residents who are financially vulnerable but do not meet one of the identified categories for support.

If you are 'just about managing' and need financial support, visit www.n-somerset.gov.uk/wps

The amount of help you get will depend on your individual circumstances.





Quick links

- Free, independent and confidential advice on a wide range of matters, including housing, debt, benefits and law, is available through the Citizen's Advice Bureau. Visit www.nscab.org.uk or call 0808 278 7973



- The National Debtline agency may help you to apply for 'breathing space' to sort out your debt problems. Visit www.nationaldebtline.org

- Find out if you're entitled to any additional benefits to boost your income. Visit www.entitledto.co.uk



- If you, or someone you know, is being threatened with homelessness due to rent or mortgage arrears, contact the council's homeless prevention team on 01934 426 330 or hp.triage@n-somerset.gov.uk
- If you're worried about the rising price of food, there is guidance and advice on the council's website at www.n-somerset.gov.uk/foodsupport. There are also links



to local community fridges for discounted food on the Better Health North Somerset website. Visit www.betterhealthns.co.uk/information/food-support

- North Somerset Together can provide practical support through a network of local volunteers. Visit www.n-somerset.gov.uk/together
- North Somerset Council has worked with the Independent Food Aid Network and the Trussell Trust to produce a leaflet to help if you're worried about money. Visit www.n-somerset.gov.uk/worryingaboutmoneyleaflet
- Sign up to weekly emails from MoneySavingExpert's Martin Lewis. Visit www.moneysavingexpert.com

Transformation of Weston-super-Mare accelerating

The transformation of culture, leisure and retail in Weston-super-Mare has received a significant boost thanks to £23m of funding.

Exciting regeneration projects are being planned across the town after North Somerset Council was awarded £20m from the government's Levelling Up Fund earlier this year, matched with £3m of its own funds.

The money is designed to create jobs and boost the economy and will be used to reinvent iconic heritage buildings, support local businesses, and deliver a year-round economy for the future.

Several high-profile sites are receiving investment.

Birnbeck Pier

Work to restore historic and much-loved Grade II* Birnbeck Pier may be able to proceed soon.

After significant delays, the Compulsory Purchase Order (CPO) inquiry regarding the transfer of Birnbeck Pier to North Somerset Council is expected to take place at the end of July, at the Town Hall in Weston-super-Mare.

The CPO was first served to the private owner in 2020 but due to an objection put to the courts by the

owner asking for a 'stay', the CPO has not yet been through the formal inquiry process required.

The owner finally withdrew his case last November, allowing the formal CPO process to proceed.

If successful, North Somerset Council can secure ownership and move forward with saving the Victorian pier from decline.

Project managers and architects have been appointed and a planning application is expected to be submitted later this year, with work starting in 2024.

The wider pier project has already secured emergency funding to strengthen the pier 'legs' and save it from collapse, with £3.55m from the National Heritage Memorial Fund.

The first payment of £234,760 from a £4.52m funding pot from the National Heritage Lottery Fund will also be used to develop detailed proposals for the restoration and reuse of Birnbeck's buildings.

The additional Levelling Up Fund money will allow buildings at the pier to be restored and brought back into use, creating facilities such as a visitor centre and café.

Tropicana



An exercise was launched in March to invite potential operators to submit their ideas for the future running of the iconic building.

The response was extremely positive and the discussions are helping North Somerset Council confirm plans for this unique seafront location.

This includes expanding the capacity to 8,000 and enhancing the outdoor area so it can be used as an arena for larger events and mini festivals.

Marine Lake

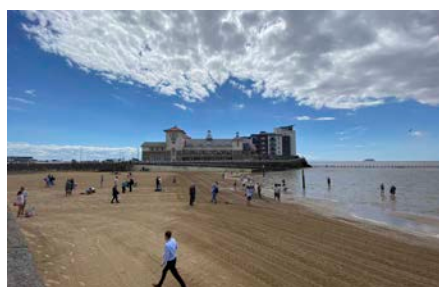

Marine Lake underwent a £300,000 upgrade last year to help turn it into a destination for water sports and outdoor swimming.

The popular lake was closed and drained to allow 30,000 tonnes of compacted silt to be removed.

Further works are still needed and Levelling Up funding will be used to do this.

This includes completing the dredging of the deep end, finishing repairs to the surround and installing extra facilities for users.

Surveys are under way and this additional work will begin this autumn.

Grove Park



Grove Park is an important place for local people to enjoy and relax.

Levelling Up Funding will be used to improve the entrance, including improved toilet facilities.

North Somerset Council will be working with groups such as the Friends of Grove Park to understand what they'd like to see there.

Weston town centre



Empty retail units are the focus of investment in Weston town centre.

Surveys have been carried out and the first set of empty units will be refitted in the autumn to make them more attractive for potential tenants.

A sustainable future

These projects have been chosen because they were identified as priorities during consultation for the creation of the SuperWeston placemaking strategy.

North Somerset Council is working with partners and contractors to maximise the long-term benefits of Levelling Up Fund investments.

This includes targeting jobs and training for those who live nearby and working with local community groups to involve them in how the facilities will be developed and used.

Projects will be as environmentally sustainable as possible, such as sourcing sustainable materials.

Visit www.superweston.net

Hear what's super about Weston

A podcast has launched to shine a spotlight on Weston-super-Mare through conversations with local people doing great things.

The We are Super Weston podcast launched in May to support the SuperWeston placemaking strategy, which aims to help Weston become a greener, healthier, and more prosperous place to live.

The fortnightly show is hosted by former radio show host, comedian and life coach Becky Walsh.

The initiative is funded by North Somerset Council, Weston Town Council, Weston BID and The Grand Pier for the Weston Place Agency.

Visit superweston.buzzsprout.com

Find a job in care to suit your lifestyle



Finding a job which makes a real difference in the community while fitting in around other commitments might be easier than you think.

More care workers are urgently needed in North Somerset to help some of the area's most vulnerable residents.

Whether you're returning to work after a break or looking for a change in career, there is a variety of jobs in the health and social care sector which could fit around your life.

We care.
Could you?

Becoming a care worker means you could make a positive impact on people's lives.

Some of the most in-demand jobs include working in people's homes to help them remain independent or support them to access services in their community, working in nursing and care homes, supporting someone with a learning disability or mental health condition, or being a personal assistant.

Yves Tshomba, a domiciliary care worker from Weston-super-Mare, won the Home Care Worker Award at the Great British Care Awards in March this year.

He was nominated by colleagues and clients at Access Your Care, one of North Somerset Council's domiciliary care lead providers.

Yves said: "I decided to join the care sector so I could play a role in supporting those who are vulnerable and give them little of the happiness life has to provide.

"It was the greatest decision in my career. I come across amazing people with incredible stories.

"To receive this award from an organisation I admire so much makes me totally happy and grateful. To be honoured by your peers is incredibly gratifying and I am so thankful."



Yves Tshomba

Q&A with Poppy Carson, Proud to Care Project Lead

Why is there such a demand for care workers?

Due to our ageing population, there will always be a demand for people who can help others stay as independent as possible, whether that's in the person's own home or a care home. You'll be helping them get the most out of each day.

Can it fit around my life?

Working in social care can provide a great work/life balance. You can work part time, doing split shifts to allow for the school run, or working hours to fit around your family or other commitments.

Does it mean unsociable hours?

It may do – but helping people get ready for bed, making sure they're safe for the night, and bringing a smile to them during weekends and holidays, can be very rewarding. It's also good for your own wellbeing to know that your time is having a positive impact on other people's lives.



Poppy Carson

What qualifications can I get? How can I develop my career?

Working in care brings many opportunities for development. With experience you may specialise in a certain area or become a team leader. With further qualifications you could progress as a manager, social worker or occupational therapist. However, you don't need to do formal qualifications if you choose not to, as you'll be developing transferrable skills and gaining life experience.

How do I get a job?

You can apply direct and receive on-the-job training. Having the right values is the most important thing. If you are kind and enjoy helping others, there will be a job for you. Other routes into the care sector including college courses and apprenticeships.

Speak to the Proud to Care team and find out more about working in the health and social care sector at a recruitment event later this year.

Drop in to Strode Leisure Centre, in Clevedon, from 10am-4pm on Wednesday 6 September.

North Somerset Council will also be visiting local schools to talk about the Proud to Care campaign, and developing a health and care ambassador scheme.

Find out more and see the full range of jobs at
www.beproudtocare.co.uk

For more information or to arrange an informal chat email proudtocare@n-somerset.gov.uk or call 01275 885 234.

The Proud to Care campaign is led by the local authorities in Bristol, North Somerset and South Gloucestershire (BNSSG).



Improving play areas for all



Play areas across North Somerset have become brighter and better places for all children to enjoy thanks to hundreds of thousands of pounds investment.

During the last year, improvements have been carried out to make play areas more accessible and inclusive to children and young people of all ages, from toddlers to teenagers and those with special educational needs and/or disabilities.

Play areas are important to communities and are vital for children's physical, mental and emotional health.

Free, outdoor play can boost resilience, confidence and social skills.

Seven of North Somerset Council's own play areas were improved after the council committed to £300,000 investment from its capital budget.

A consultation was carried out last summer and feedback received gave the council a better understanding of what families wanted and what the priorities should be.

In addition to North Somerset Council's own play areas, 23 play areas run by town and parish councils, community groups and a Business Improvement District have also been improved thanks to the £250,000 Improving Play Spaces Fund.

Organisations could apply to this fund and had to agree to match-fund the amount they received, therefore doubling the investment amount.

Awards ranged from £2,000 to £25,000 and play areas of different sizes across the area benefitted, from one piece of equipment to multiple pieces.

In Castle Batch, in Worle, Weston-super-Mare, an all-inclusive play area has been built, providing opportunities for physical development, sensory simulation and social interaction.

Two brand new play areas have also been created, at Alexandra Gardens in Clevedon and at Failand Village Hall.



£300,000 investment in North Somerset Council-owned play areas



Plumley Park
Weston-super-Mare
← Before - After →



Scotch Horn
Nailsea
← Before - After →



£250,000 investment thanks to the Improving Play Spaces Fund



Portishead Lake Grounds
← Before - After →



New play area
at **Alexandra Gardens**
Clevedon



New play area at
Failand Village Hall

There are more than 50 play areas across North Somerset that are free for all to use. Find your local one at www.n-somerset.gov.uk/playareas



Residents get Hard Hat Ready

Six local people looking for work have been learning construction skills on a new course held at the site of a secondary school expansion currently being built in Weston-super-Mare.

The three-week Hard Hat Ready courses are taking place at Winterstoke Hundred Academy Expansion in Locking Parklands, and offer residents the opportunity to explore a career in construction.

The courses, hosted in partnership with project contractors Kier and Weston College, give participants the chance to learn key employability skills, take part in hands-on work experience such as health and safety and site management, and study and gain a Construction Skills Certification (CSCS) card.

In addition, attendees also have the chance to meet employers in the

industry which, in combination with the CSCS card, can help open doors to jobs in construction.

Hard Hat Ready is taking place at the Sustainability Lab on the site of the Winterstoke Hundred Academy Expansion.

The Sustainability Lab is a learning pavilion that will offer both young people and adults the chance to learn how they can access jobs and training in the growing green construction industry.

Some of the future workshops and activities hosted there will focus on sustainability and construction training, both run in both small

groups and on a one-to-one basis.

Once the expansion of Winterstoke Hundred Academy opens, the Sustainability Lab will continue as a space for community use.

The school expansion will provide up to 900 school places so that more young people can access schooling in North Somerset.

The three-storey building is designed to some of the highest standards of sustainability, set to achieve Net Zero carbon in operation, a much-sought BREEAM 'excellent' rating for energy efficiency and a 10 per cent biodiversity net gain, which will protect and promote plants and wildlife.



North Somerset Life

North Somerset *Life* is published by North Somerset Council and delivered to 100,000 households.

For advertising and sponsorship opportunities contact tim.brown@n-somerset.gov.uk

For editorial contact editor@n-somerset.gov.uk or 01275 884 139

The next edition will be delivered in **autumn 2023**.

Your copy should be delivered with your post unless you use Royal Mail's opt-out service to block unaddressed mail.

View back issues at www.northsomersetlife.co.uk



Get the latest news straight into your inbox



Stay up-to-date with council news, events and services by signing up to the North Somerset *Life* email newsletter.



Subscribe online and stay informed at www.northsomersetlife.co.uk

Contacts

Call us

If you would like help to access additional information about any of the subjects covered in this magazine, call the contact centre on **01934 888 888** (Mon-Fri, 9am-5pm). This is an automated service so you'll need to ask for the service you are looking for.

Direct numbers for other popular services:

For waste and recycling, road issues, planning and building control:

01934 888 802

(Mon-Fri, 9am-5pm)

For council tax and benefits:

01934 888 144

(Mon-Fri, 9am-5pm)

For social services:

01275 888 801

(Mon-Fri, 8am-6pm)



Do it online – report it, request it or pay for it at:

www.n-somerset.gov.uk/connect

Or go straight to these popular web pages by adding these shortcuts: www.n-somerset.gov.uk/myaccount / [planning](http://www.n-somerset.gov.uk/planning) / [schooladmissions](http://www.n-somerset.gov.uk/schooladmissions) / [wastecollections](http://www.n-somerset.gov.uk/wastecollections) / [termdates](http://www.n-somerset.gov.uk/termdates)



Tide times

Check tide times online at www.n-somerset.gov.uk/tidetimes

Tide predictions are computed by the Proudman Oceanographic Laboratory and adjusted for Greenwich Mean Time (GMT) and British Summer Time (BST) differences.

- For Clevedon – add 10 minutes.
- For Portishead – add 18 minutes.



Walks in the area are available to view and download at www.northsomersetlife.co.uk

Book on-demand buses to travel at a time that suits you.

WESTlink services go where they're needed and run without a set timetable.

Use it to visit friends, get to work, go shopping, attend an appointment – or connect onto a main bus route.

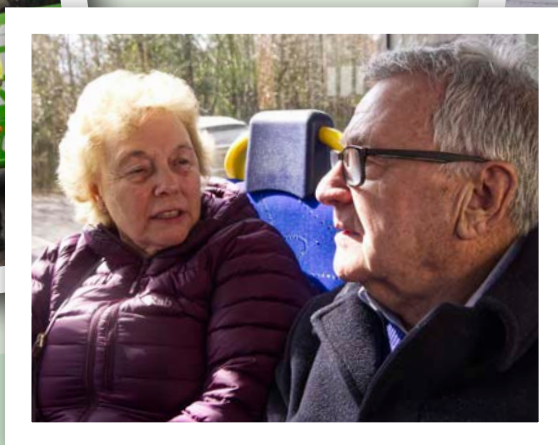

The new on-demand service, funded by the Department of Transport, can be booked through an app, website or on the phone:

Free app – search for **WESTlink** on the Apple App Store or Google Play

Phone the call centre on **0117 457 8561**, charged at local rates

Visit **www.westlink.app**



Funded by
UK Government

**WEST OF
ENGLAND**
Combined Authority

 **North
Somerset**
Council

WESTlink